

SL02 STEP LIGHT

SL02

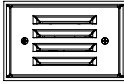

PROJECT:

TYPE:

DATE: 08/26/2025

CATALOG NUMBER:



SL02L12BLT
(4 Louver-Standard)



SL023LL12BRS
(3 Louver-3L)



SL021LL12COP
(1 Louver-1L)



SL02ALL12SS
(Acrylic Lens-AL)

CATALOG ORDER LOGIC

EXAMPLE: SL02L12BRS

FIXTURE

SL Specialty Light

TYPE

02 Step Light (Residential)

FACE PLATE OPTIONS

- ☐ Blank Standard 4 Louver
- ☐ AL Acrylic Lens
- ☐ 1L 1 Louver
- ☐ 3L 3 Louver

12 VOLT LED	WATT	SOCKET	KELVIN	LUMEN
<input type="checkbox"/> NL (No Lamp)		Ba15s Single Contact		
<input type="checkbox"/> NLBP (No Lamp)		G4 Bi-Pin		
<input type="checkbox"/> L10	3w	G4 Bi-Pin	3000K	300lm
<input type="checkbox"/> L12	3w	Ba15s Single Contact	3000K	300lm
<input type="checkbox"/> L13	3w	G4 Bi-Pin	2700K	270lm
<input type="checkbox"/> L14	3w	G4 Bi-Pin	3000K	270lm
<input type="checkbox"/> L15	3w	Ba15s Single Contact	2700K	270lm
<input type="checkbox"/> L16	3w	Ba15s Single Contact	3000K	270lm
<input type="checkbox"/> L17	3w TF	G4 Bi-Pin	Amber	585-595nm
<input type="checkbox"/> L18	3w TF	Ba15s Single Contact	Amber	585-595nm

(TF) Turtle Friendly Light Source

120 VOLT LED	WATT	SOCKET	KELVIN	LUMEN
<input type="checkbox"/> NL120VDC		Ba15d Double Contact		
<input type="checkbox"/> NL120VBP		GY6.35 Bi-Pin		
<input type="checkbox"/> L160	3w	GY6.35 Bi-Pin	3000K	400lm

BACK BOX

- ☐ NB No Back Box

WIRING OPTION

- ☐ 25F 25 Feet Lead Wire (12v Only)

FINISH

- ☐ BLT Aluminum: Black Texture polyester powder coat finish
- ☐ BRT Aluminum: Bronze Texture polyester powder coat finish
- ☐ BRS Brass: Unfinished (See page 3 for more options)
- ☐ COP Copper: Unfinished (See page 3 for more options)
- ☐ SS Stainless Steel: Unfinished

More polyester powder coat finishes or acid treatments available. See page 3 for more information

MATERIAL	SHIP WEIGHT	CARTON DIMENSIONS
Aluminum 6061	1 lbs.	6.00" x 4.00" x 4.00"
Brass C27200	2 lbs.	6.00" x 4.00" x 4.00"
Copper	1 lbs.	6.00" x 4.00" x 4.00"
Stainless Steel 316	1.5 lbs.	6.00" x 4.00" x 4.00"

IP54 IP66



FOCUS INDUSTRIES INC.
25301 COMMERCE CENTRE DRIVE
LAKE FOREST, CA. 92630
949.830.1350 | TOLL FREE: 888.882.1350
WWW.FOCUSINDUSTRIES.COM

DESIGNED. 
MANUFACTURED.
IN THE USA.

SL02 STEP LIGHT

SL02

PROJECT:

TYPE:

DATE: 08/26/2025

CATALOG NUMBER:

DIMENSIONS

Dimensions Shown

SL02L12

4 Louver Version

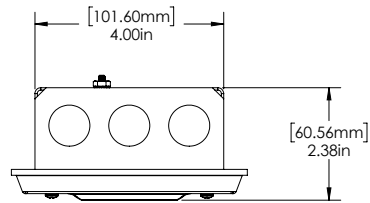

TOP VIEW

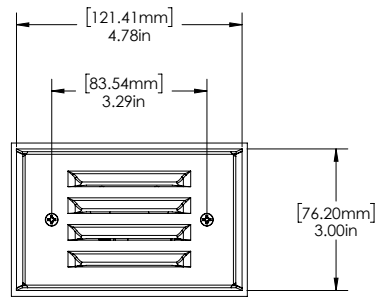

FRONT VIEW

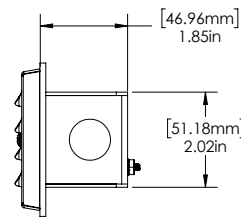

SIDE VIEW

Dimensions Shown

SL02ALL12

AL Acrylic Lens Version

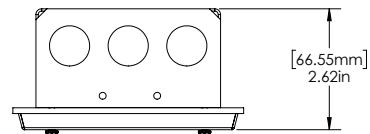

TOP VIEW

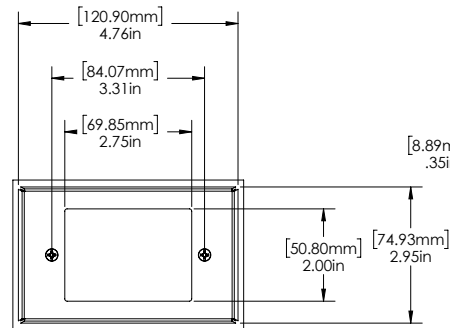

FRONT VIEW

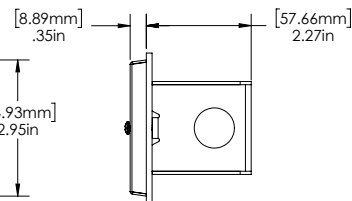

SIDE VIEW

IP54 IP66



FOCUS INDUSTRIES INC.
25301 COMMERCE DRIVE
LAKE FOREST, CA. 92630
949.830.1350 | TOLL FREE: 888.882.1350
WWW.FOCUSINDUSTRIES.COM

DESIGNED.
MANUFACTURED.
IN THE USA.



SL02 STEP LIGHT

SL02

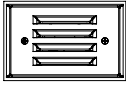

PROJECT:

TYPE:

DATE: 08/26/2025

CATALOG NUMBER:

DIMENSIONS

Dimensions Shown SL021LL12

1 Louver Version

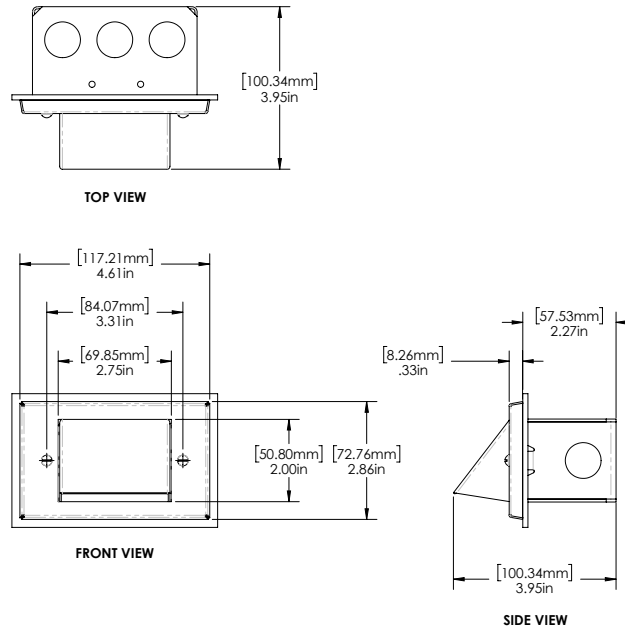

Dimensions Shown SL023LL12

3 Louver Version

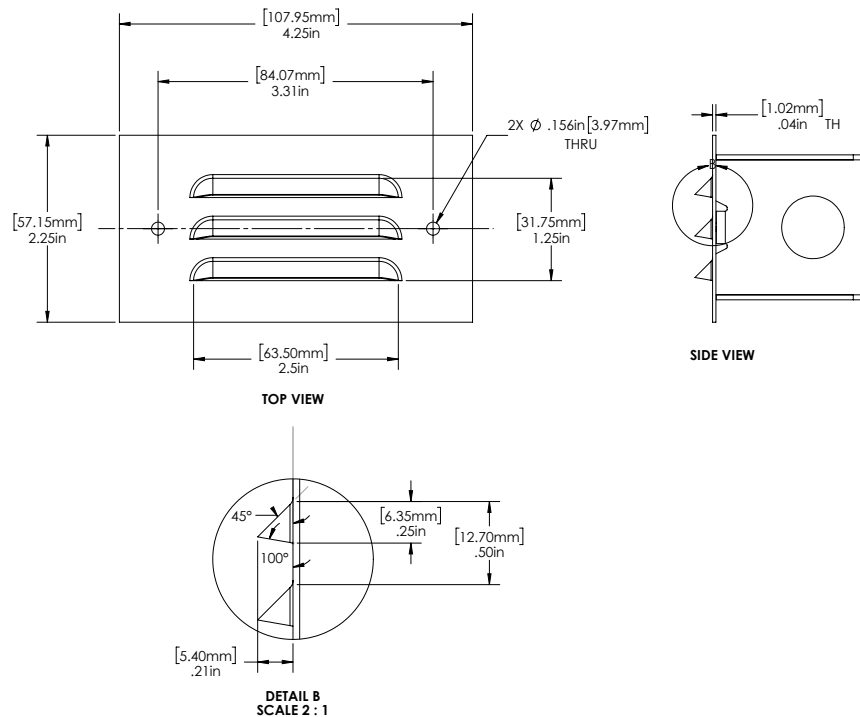

IP54 IP66



FOCUS INDUSTRIES INC.
25301 COMMERCENTRE DRIVE
LAKE FOREST, CA. 92630
949.830.1350 | TOLL FREE: 888.882.1350
WWW.FOCUSINDUSTRIES.COM

DESIGNED. 
MANUFACTURED.
IN THE USA.

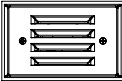



SL02 STEP LIGHT

PROJECT:

TYPE:

DATE: 08/26/2025

CATALOG NUMBER:

SPECIFICATIONS		
<div> <div>INTERNALS</div> <div>  <div>Click Icon to Download</div> <div>IP54</div> <div>IP66</div> </div> </div>	VOLTAGE WIRING	12 Volt: Standard 36.00" Black AWG 2/C,SPT1-W,300V UL (Power with magnetic transformer) 120-277 Volt: 36" 18AWG black, white, and green (ground) (Power with line voltage)
	CONNECTOR	Nut twist winged, insulated nylon, 16-14 AWG, blue
	GASKET	Close cell sponge, 0.190" THK, 1-S adhesive
	REFLECTOR	6.00" aluminum specular
<div> <div>EXTERNALS</div> <div>  <div>Click Icon to Download</div> <div>IP54</div> <div>IP66</div> </div> </div>	MATERIALS	6061 aluminum, C27200 brass, copper, and 316 stainless steel
	BACK BOX	Aluminum, 1.85" deep, with 2 knockouts
	FINISH	Aluminum: Standard BLT/BRT - black or bronze texture polyester powder coat (More options available, see page 3) Brass: Standard unfinished (More options available, see page 3) Copper: Unfinished (More options available, see page 3) Stainless Steel: Unfinished
	LISTINGS	IP54 (SL02/SL023L) IP66 (SL02AL/SL021L) MADE IN THE USA

FINISHES

STANDARD FINISHES



Black Texture (-BLT)

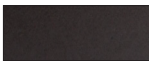

Bronze Texture (-BRT)

CUSTOM FINISHES

Supply RAL or Pantone here

RAL #:

Need help finding a RAL color?

<https://www.ralcolor.com/>

PANTONE #:

Need help finding a Pantone color?

<https://www.pantone.com/color-finder>

PREMIUM FINISHES



Dark Bronze (-DBZ)



Black Magic (-BKM)



White Gloss (-WHT)



White Texture (-WTX)



Stucco (-STU)

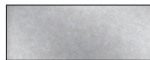

Chrome Powder (-CPR)



Weathered Iron (-WIR)



Weathered Brown (-WBR)



Rust (-RST)



Luna (-LUN)



Rubbed Verde (-RBV)



Hunter Texture (-HTX)



Mineral Bronze (-BRZ)



Semi-Gloss Black (-BLK)

ACID FINISHES

Brass and Copper fixtures only



Acid Rust Copper (-CAR)
Brass (-BAR)



Black Acid Treatment (-BAT)



Acid Verde Copper (-CAV)
Brass (-BAV)



landscape • architectural • hospitality • entertainment • illumination

FOCUS INDUSTRIES INC.

25301 COMMERCENTRE DRIVE

LAKE FOREST, CA. 92630

949.830.1350 | TOLL FREE: 888.882.1350

WWW.FOCUSINDUSTRIES.COM

DESIGNED.

MANUFACTURED.

IN THE USA.



THIS DOCUMENT CONTAINS INFORMATION PROPRIETY OF FOCUS INDUSTRIES, AND ITS POSSESSION DOES NOT GRANT ANY RIGHTS TO REPRODUCE, MANUFACTURE, SELL, OR DISCLOSE THE CONTENTS DESCRIBED IN THIS DOCUMENT. REPRODUCTION, DISCLOSURE, AND MANUFACTURING WITHOUT THE WRITTEN CONSENT AND AUTHORIZATION OF FOCUS INDUSTRIES IS STRICTLY FORBIDDEN.

08/26/2025

4