



# INSTALLATION INSTRUCTIONS 120 VOLT WALL MOUNT

INSPECTED BY:

**CAUTION:** To prevent electrical shock, turn off power at fuse box, junction box, or circuit breaker panel before installation or service.

**NOTE:** Must be installed by a licensed electrician per local codes.



**MATERIAL SUPPLIED**  
120v wall mount fixture  
and hardware



Focus fixture designed to be compatible with single gang, 3" Octagon electrical box or 4"Ø electric box.

## INSTALLATION:

1. Attach universal mounting plate over junction box with 2 x 8-32 x 1/2" Phillips Pan Screws (See Figure 1).
2. Level hex spacers on mounting plate (See Figure 2).
3. Remove 1 side of adhesive protection from gasket (See Figure 3).
4. Align gasket holes with mounting spacer and place over mounting box. Pull wires through hole (See Figure 4).
5. Remove connectors from wires (See Figure 5).
6. To connect the fixture, connect black to black wire, white to white wire, and green wire to ground (See Figure 6).
7. When connection is done, place wire connection back into junction box (See Figure 7).
8. Mount fixture to the spacers, use 2 x 8-32 x 5/8" Phillips flat head screws provided (See Figure 8).
9. Installation is complete (See Figure 9).

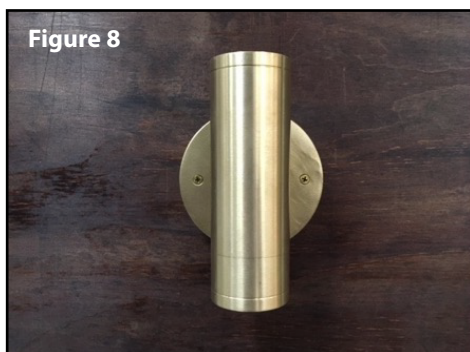
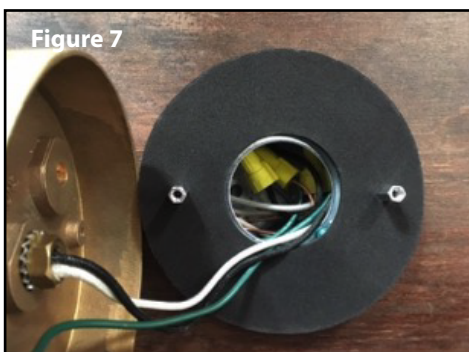
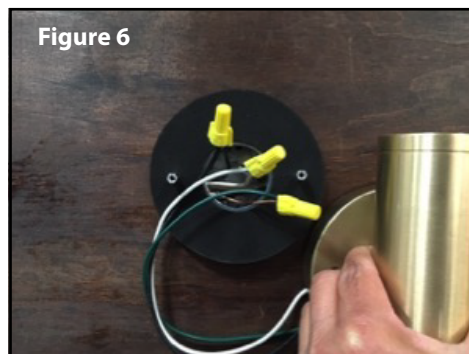
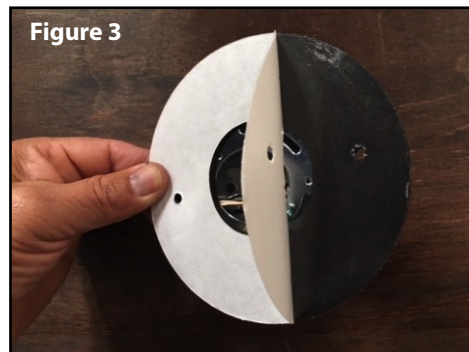
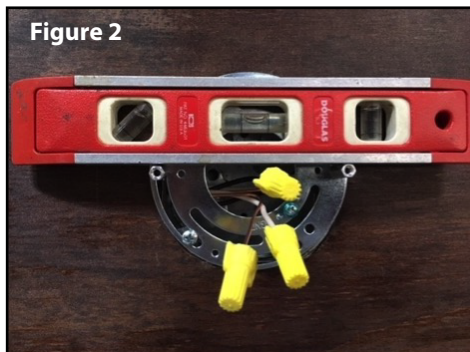
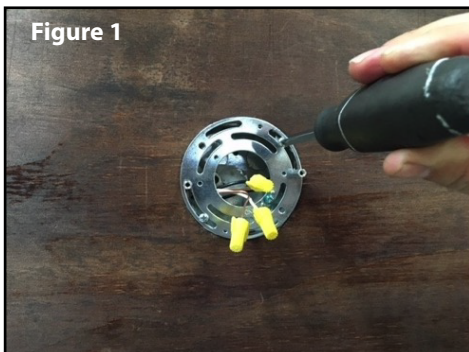

For Questions Call 1-888-882-1350